



**1051**  
N RUSH  
STREET

L3 Capital

**PREMIER CORNER** AT THE INTERSECTION OF RUSH, STATE, & CEDAR STREETS  
**GOLD COAST** | Chicago's Most Exclusive Retail Neighborhood



	WALK RADIUS	DAYTIME POP.	MEDIAN HH INCOME
<b>GOLD COAST CHICAGO</b>	5-min.	+8,000	+\$151,580
	10-min.	+32,240	+\$110,990
	15-min.	+57,370	+\$112,900



Join **Away, Warby Parker, Grown Brilliance, Urban Outfitters,** and more, at the intersection of Rush, State, and Cedar streets.



PREMIER **CORNER** LOCATION

**DOUBLE-HEIGHT** ENTRANCE  
WITH **PROMINENT BRANDING**  
OPPORTUNITY

**ENTIRE GROUND FLOOR +**  
LOWER-LEVEL STORAGE

**AVAILABLE NOW**

WITHIN 3 BLOCKS

**On Running, Arfc'teryx, Alice + Olivia, Hermès, Prada, Cartier, Celine, Anine Bing, Glossier & more**

\$100M in restaurant sales across 6 restaurants within ½ block perimeter of site

**Two nationally ranked top-grossing independent restaurants: Gibson's and Maple & Ash**

Two 5-star luxury hotels: Waldorf Astoria & Viceroy Hotel

**SIZE**

**G** – 2,319 RSF

**LL** – 2,471 RSF

**FRONTAGE**

**24'6"** on N Rush St

**27'** wraparound on  
E Cedar St

# E CEDAR ST

N STATE ST

N RUSH ST

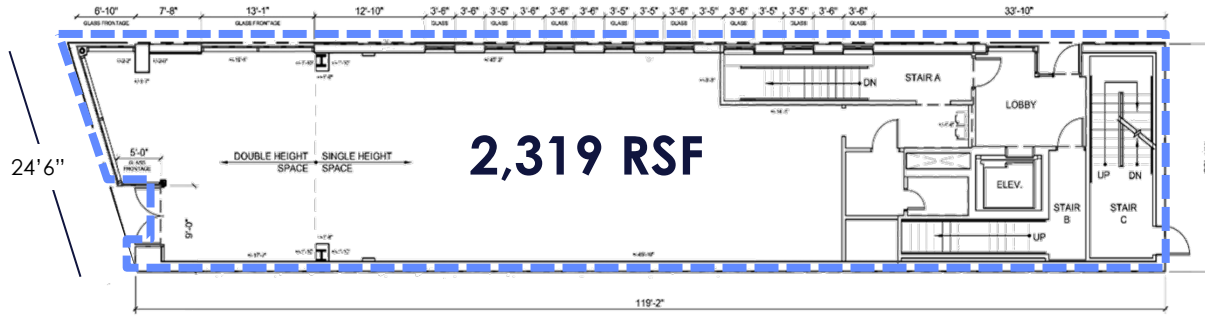

G

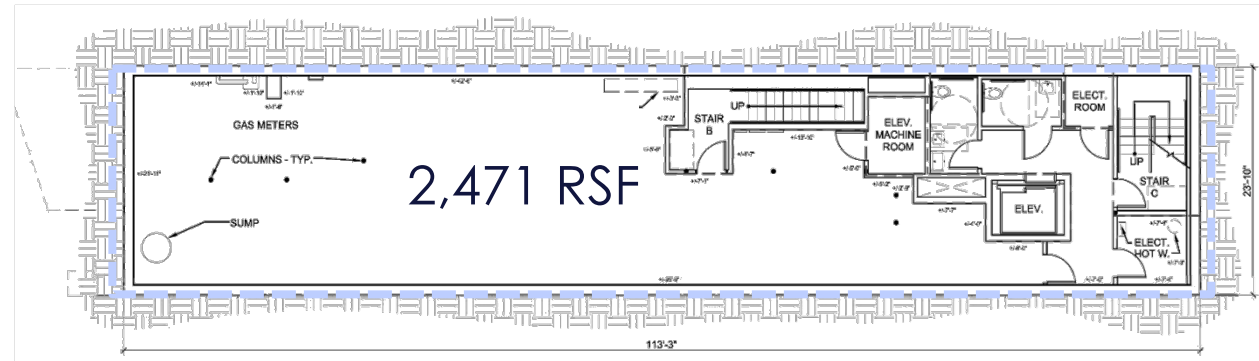

LL



**1051**  
N RUSH  
STREET

L3 Capital





**1051**  
N RUSH  
STREET

L3 Capital



[WWW.L3CAPITAL.COM](http://WWW.L3CAPITAL.COM)